

JANOME

Automatic Screw Presenter



Dependable Delivery: Janome Autom

Broad Compatibility

Usable with a wide range of ferrous, non-ferrous and other screw types.



Manual and Robot Types Available

We offer different models for handheld screwdrivers and robot-mounted screwdrivers; screw sizes M1.0~M5.0.



Manual Model



Robot Model

Easy Changeover for Greater Versatility

Just replace the rail to change to a different screw size.

- JSP-RSD/JSP-MS Series: compatible with 8 different sizes.
- JSP-R/JSP-M Series: compatible with 3~4 different sizes.

Dependable Delivery

Horizontal method for smooth and steady screw presentation.



Pickup Point

Overload Protection Function

If there are too many screws in the scooping chamber and the screws stop coming, the motor runs in reverse for a short time to let the presenter correct itself. If the presenter does not return to normal, the safety function cuts off the motor power.

External Output Signal

All models come with an external output signal line as a standard accessory.

| | |
|--------|---|
| Manual | Outputs a signal when a screw is picked up |
| Robot | Outputs a signal for screw presence/absence |

Mounting Plates for Robot Installation

We offer mounting plates of various types, directions and heights for installation on our desktop robots.

Space-saving

Compact size ideal for mounting even on a small desktop robot with a narrow footprint.



Automatic Screw Presenter

Model Code

JSP -

R45

35

Model

Janome Automatic Screw Presenter

Type

Manual

MS: Manual type / Small size
M 23: Manual type (rail size 23)
M 45: Manual type (rail size 45)





Robot

RSD: Robot type / Small size / Disc type
R 23: Robot type (rail size 23)
R 45: Robot type (rail size 45)

Screw Size

10: M1.0
12: M1.2
14: M1.4
17: M1.7
20: M2.0
23: M2.3
26: M2.6
30: M3.0
35: M3.5
40: M4.0
50: M5.0

Model Selection Chart

| Application | Manual | | Robot | |
|--------------------------------|---|---|---|---|
| Series Name | JSP-MS Series | JSP-M Series | JSP-RSD Series | JSP-R Series |
| Type | Compact | Standard | Compact | Standard |
| Type |  |  |  |  |
| Compatible Screw Size | Model Name | | Model Name | |
| M1.0 | JSP-MS10 | - | JSP-RSD10 | - |
| M1.2 | JSP-MS12 | - | JSP-RSD12 | - |
| M1.4 | JSP-MS14 | - | JSP-RSD14 | - |
| M1.7 | JSP-MS17 | - | JSP-RSD17 | - |
| M2.0 | JSP-MS20 | JSP-M2320 | JSP-RSD20 | JSP-R2320 |
| M2.3 | JSP-MS23 | JSP-M2323 | JSP-RSD23 | JSP-R2323 |
| M2.6 | JSP-MS26 | JSP-M2326 | JSP-RSD26 | JSP-R2326 |
| M3.0 | JSP-MS30 | JSP-M2330 | JSP-RSD30 | JSP-R2330 |
| M3.5 | - | JSP-M4535 | - | JSP-R4535 |
| M4.0 | - | JSP-M4540 | - | JSP-R4540 |
| M5.0 | - | JSP-M4550 | - | JSP-R4550 |
| Maximum Screw Shaft Length | 20mm | 18mm | 20mm | 18mm |
| Screw Supply Volume | 80cc | 150cc | 80cc | 150cc |
| Cycle Time | - | - | 0.9sec | 1.5sec |
| External Dimensions W×D×H (mm) | 123×181×145.9 | 129.4×215×138.5 | 123×181×145.9 | 133.4×274×138.5 |
| Weight (with rail) | 2.9kg | 3.7kg | 3.0kg | 4.4kg |
| Power Supply | Input | AC100~240V (single phase) 50/60Hz | | |
| | Output | DC15V 2.4A AC adapter | | |
| Operating Environment | Temperature | 0~40°C | | |
| | Humidity | 10~90% | | |

[Standard Accessories]

- AC Adapter (100V~240V)
- Power Cord
- Operation Manual
- Hex Wrench
- Adjustment Screwdriver
- Grounding Wire
- 0.35mm Gauge Plate (JSP-MS Series only)

JSP-MS Series

- Compact size screw presenter for manual pickup
- Change the rail for use with eight different screw sizes from M1.0~M3.0.

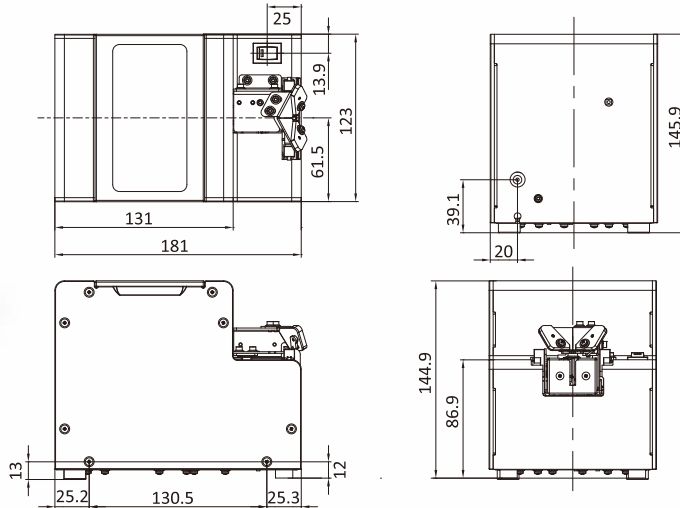

JSP-RSD Series

- Compact size screw presenter for robots
- Change the rail for use with eight different screw sizes from M1.0~M3.0.
- Rotary escaper prevents screws from bunching up at the delivery point.

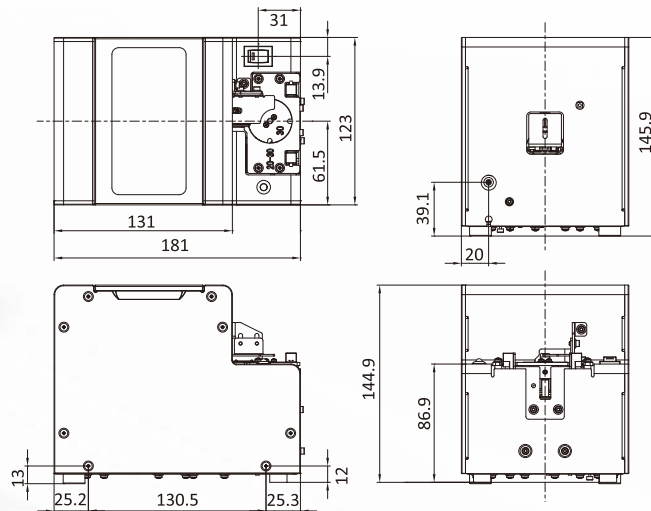

JSP-MS & JSP-RSD Series Screw Compatibility Reference Guide

| Model | | Screw Compatibility | | | | |
|----------|-----------|---------------------|-------------------|------------------|--------------------|------------------|
| Manual | Robot | Screw Size | Shaft Diameter(Φ) | Head Diameter(Φ) | Head Thickness(mm) | Shaft Length(mm) |
| JSP-MS10 | JSP-RSD10 | M1.0 | 0.9~0.95 | 1.8~4.5 | 0.35~1.0 | 1.6~10 |
| JSP-MS12 | JSP-RSD12 | M1.2 | 1.1~1.15 | 1.8~4.5 | 0.35~1.0 | 1.9~10 |
| JSP-MS14 | JSP-RSD14 | M1.4 | 1.3~1.4 | 2.0~4.5 | 0.35~1.0 | 2.2~10 |
| JSP-MS17 | JSP-RSD17 | M1.7 | 1.6~1.7 | 2.0~4.5 | 0.35~1.0 | 2.7~10 |
| JSP-MS20 | JSP-RSD20 | M2.0 | 1.9~2.1 | 3.0~6.0 | 0.35~4.5 | 3.2~20 |
| JSP-MS23 | JSP-RSD23 | M2.3 | 2.2~2.4 | 3.3~6.0 | 0.35~4.5 | 3.7~20 |
| JSP-MS26 | JSP-RSD26 | M2.6 | 2.5~2.7 | 3.6~6.0 | 0.35~4.5 | 4.2~20 |
| JSP-MS30 | JSP-RSD30 | M3.0 | 2.9~3.2 | 4.0~6.0 | 0.35~4.5 | 4.8~20 |

*Compatible with washers up to diameter 9mm, thickness 0.35~1.0mm. *Not compatible with some screw shapes.

JSP-M Series

- Standard size screw presenter for manual pickup
- Change the rail for use with 4 different screw sizes with the M23 Type or 3 different screw sizes with the M45 Type.
- Scooping chamber screw supply capacity up to 150cc.

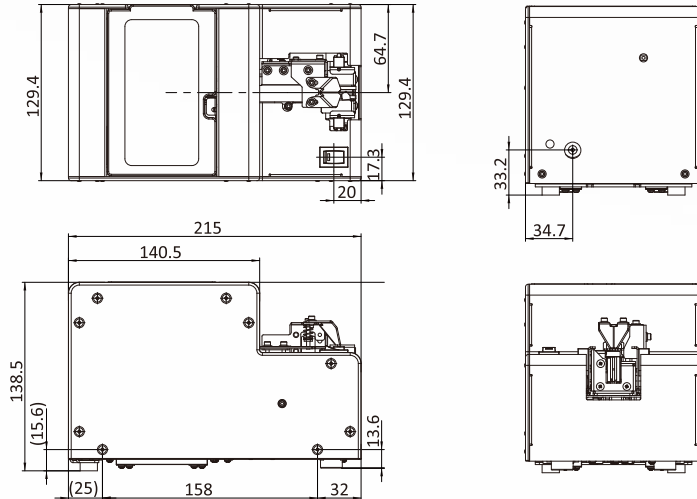

JSP-R Series

- Standard size screw presenter for robots
- Change the rail for use with 4 different screw sizes with the R23 Type or 3 different screw sizes with the R45 Type.
- Scooping chamber screw supply capacity up to 150cc.

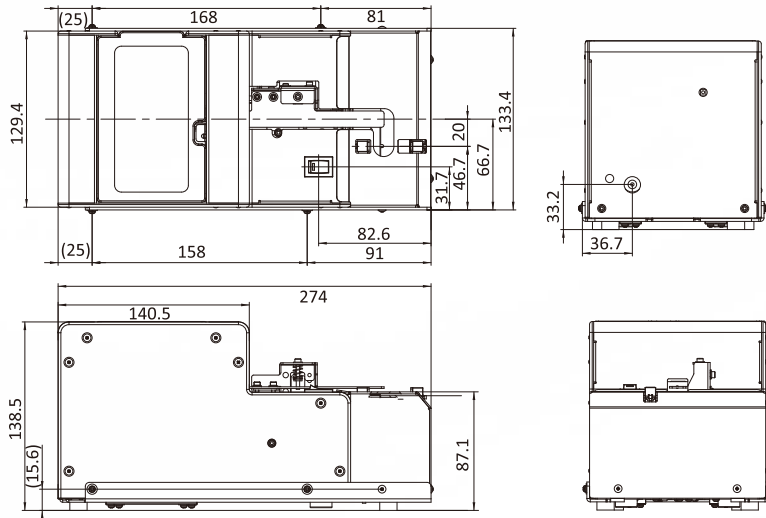

JSP-M & JSP-R Series Screw Compatibility Reference Guide

| Model | | Screw Compatibility | | | | | |
|-----------|-----------|---------------------|-------------------|------------------|---------------------|--------------------|------------------|
| Manual | Robot | Screw Size | Shaft Diameter(Φ) | Head Diameter(Φ) | Washer Diameter(mm) | Head Thickness(mm) | Shaft Length(mm) |
| JSP-M2320 | JSP-R2320 | M2.0 | 1.8~2.1 | 3.0~3.5 | 3.0~8.0 | 0.5~5.5 | 3.2~18.0 |
| JSP-M2323 | JSP-R2323 | M2.3 | 2.1~2.4 | 3.3~4.0 | 3.3~8.0 | 0.5~5.5 | 3.7~18.0 |
| JSP-M2326 | JSP-R2326 | M2.6 | 2.4~2.7 | 3.6~4.5 | 3.6~8.0 | 0.5~5.5 | 4.2~18.0 |
| JSP-M2330 | JSP-R2330 | M3.0 | 2.8~3.1 | 4.0~5.5 | 4.0~8.0 | 0.5~5.5 | 4.8~18.0 |
| JSP-M4535 | JSP-R4535 | M3.5 | 3.3~3.7 | 4.8~8.0 | 4.8~12.0 | 0.5~8.0 | 5.6~18.0 |
| JSP-M4540 | JSP-R4540 | M4.0 | 3.8~4.1 | 5.4~8.0 | 5.4~12.0 | 0.5~8.0 | 6.4~18.0 |
| JSP-M4550 | JSP-R4550 | M5.0 | 4.8~5.1 | 6.2~10.0 | 6.2~12.0 | 0.5~8.0 | 8.0~18.0 |

*Compatible with washers thickness 0.4~1.0mm. *Not compatible with some screw shapes.

Replacement Parts

Replacement Rail Sets



*Single parts are also available for purchase.
Rails for Manual Types come with stoppers.

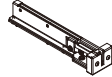
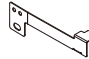

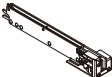
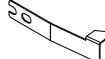
Manual Type

| Model | Screw Size | Rail Set Model No. | Rail Set Part No. for Ordering | Set Contents | | |
|--------|------------|--------------------|--------------------------------|--|---|----------------|
| | | | | Rail | Stopper | Passing Window |
| JSP-MS | M1.0 | R-MS10SET | 282401005 |  |  | W-SRM1017 |
| | M1.2 | R-MS12SET | 282401108 | R-MS12 | 282040002 | |
| | M1.4 | R-MS14SET | 282401201 | R-MS14 | 282041003 | |
| | M1.7 | R-MS17SET | 282401304 | R-MS17 | 282042004 | |
| | M2.0 | R-MS20SET | 282401407 | R-MS20 | | |
| | M2.3 | R-MS23SET | 282401500 | R-MS23 | | |
| | M2.6 | R-MS26SET | 282401603 | R-MS26 | | |
| | M3.0 | R-MS30SET | 282401706 | R-MS30 | | W-SRM2030 |

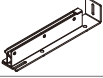
| Model | Screw Size | Rail Set Model No. | Rail Set Part No. for Ordering | Set Contents | | | |
|---------|------------|--------------------|--------------------------------|--|---|----------------|----------|
| | | | | Rail | Stopper | Passing Window | |
| JSP-M23 | M2.0 | R-M20SET | 283401008 |  |  | W-RM2320 | |
| | M2.3 | R-M23SET | 283401101 | R-M23 | | 283017003 | W-RM2323 |
| | M2.6 | R-M26SET | 283401204 | R-M26 | | W-RM2326 | |
| | M3.0 | R-M30SET | 283401307 | R-M30 | | W-RM2330 | |
| JSP-M45 | M3.5 | R-M35SET | 283401400 | R-M35 | 283017106 | W-RM4540 | |
| | M4.0 | R-M40SET | 283401503 | R-M40 | | | |
| | M5.0 | R-M50SET | 283401606 | R-M50 | | W-RM4550 | |

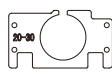
Robot Type

| Model | Screw Size | Rail Set Model No. | Rail Set Part No. for Ordering | Set Contents | | | |
|---------|------------|--------------------|--------------------------------|---|---|---|----------------|
| | | | | Rail | Escaper | Escaper Guide | Passing Window |
| JSP-RSD | M1.0 | R-RSD10SET | 280401009 |  |  |  | W-SRM1017 |
| | M1.2 | R-RSD12SET | 280401102 | R-RSD12 | E-RSD12 | | |
| | M1.4 | R-RSD14SET | 280401205 | R-RSD14 | E-RSD14 | | |
| | M1.7 | R-RSD17SET | 280401308 | R-RSD17 | E-RSD17 | | |
| | M2.0 | R-RSD20SET | 280401401 | R-RSD20 | E-RSD20 | EG-RSD20-30 | W-SRM2030 |
| | M2.3 | R-RSD23SET | 280401504 | R-RSD23 | E-RSD23 | | |
| | M2.6 | R-RSD26SET | 280401607 | R-RSD26 | E-RSD26 | | |
| | M3.0 | R-RSD30SET | 280401702 | R-RSD30 | E-RSD30 | | |

| Model | Screw Size | Rail Set Model No. | Rail Set Part No. for Ordering | Set Contents | | |
|---------|------------|--------------------|--------------------------------|--|---|----------------|
| | | | | Rail | Escaper | Passing Window |
| JSP-R23 | M2.0 | R-R20SET | 281401002 |  |  | W-RM2320 |
| | M2.3 | R-R23SET | 281401105 | R-R23 | E-R23 | W-RM2323 |
| | M2.6 | R-R26SET | 281401208 | R-R26 | E-R26 | W-RM2326 |
| | M3.0 | R-R30SET | 281401301 | R-R30 | E-R30 | W-RM2330 |
| JSP-R45 | M3.5 | R-R35SET | 281401404 | R-R35 | E-R35 | W-RM4540 |
| | M4.0 | R-R40SET | 281401507 | R-R40 | E-R40 | |
| | M5.0 | R-R50SET | 281401600 | R-R50 | E-R50 | |

Options

Robot Mounting Plates

| Screw Presenter | JSP-RSD Series | | | | | |
|-------------------------|----------------|---------------|-----------------------------------|-----------|-----------|-----------|
| Compatible Robot | JR3203 | | JR3303 / JR3403 / JR3503 / JR3603 | | | |
| Mounting Position | Regular | Side Mounting | Regular | Regular | Regular | Regular |
| Mounting Surface Height | 2 mm | 2 mm | 32 mm | 62 mm | 100 mm | 150 mm |
| Part No. for Ordering | 963656009 | 170958002 | 964638008 | 964638101 | 964639102 | 964639205 |
| Shape | | | | | | |

| Screw Presenter | JSP-R Series | | | | | |
|-------------------------|---------------|-----------|-----------------------------------|-----------|-----------|-----------|
| Compatible Robot | JR3203 | JR3303 | JR3303 / JR3403 / JR3503 / JR3603 | | | |
| Mounting Position | Side Mounting | Regular | Regular | Regular | Regular | Regular |
| Mounting Surface Height | 2 mm | 2 mm | 10 mm | 50 mm | 100 mm | 150 mm |
| Part No. for Ordering | 963628002 | 982624018 | 962613001 | 962610019 | 962610112 | 962610215 |
| Shape | | | | | | |

*Robot mounting plate dimensions vary according to screwdriver and workpiece parameters. Please confer with us when selecting a mounting plate.

Desktop Robot Installation



Install 2 screw presenters to tighten 2 different screw lengths.

• Before using our products, please be sure to check their respective operation manuals so that you can use them safely and correctly.
• Specifications may be modified without prior notice to improve product quality.
• For inquiries, please contact us at the telephone number below or through the "Contact Us" page on our website.

C51-00(02.0)EN 2023.02-000

JANOME

JANOME Corporation
Industrial Equipment Sales Division

1463 Hazama-machi, Hachioji-shi, Tokyo 193-0941, Japan
Tel: +81-42-661-6301 FAX: +81-42-661-6302
E-mail : j-industry@gm.janome.co.jp
URL: www.janome.co.jp/industrial.html